



MULTIMODAL ANALYSIS OF HUMAN BEHAVIOUR LOOKING AT A TARGET SCENE



Adel Lablack

LIFL-UMR USTL-CNRS 8022, Laboratoire d'Informatique Fondamentale de Lille, Université de Lille 1, France
adel.lablack@lifl.fr



GLOBAL APPROACH

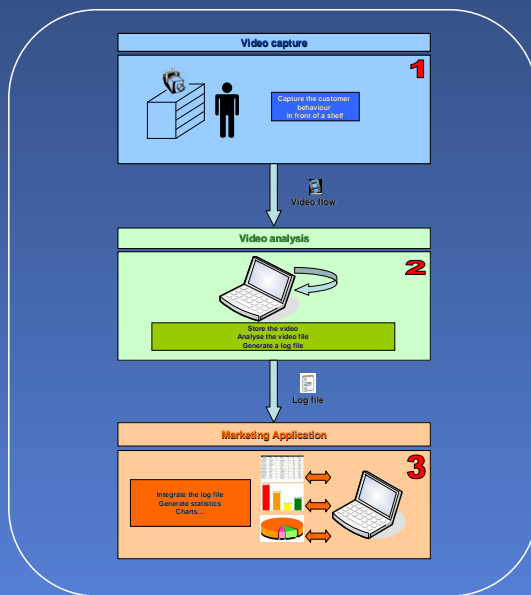

3 Modalities:

Stop/Moving

this modality refers to whether the person is moving or not.

Looking/Not looking

this modality denotes persons whose visual field is oriented towards the target scene or not.

Location of interest

this modality provides the exact location of the person's gaze.

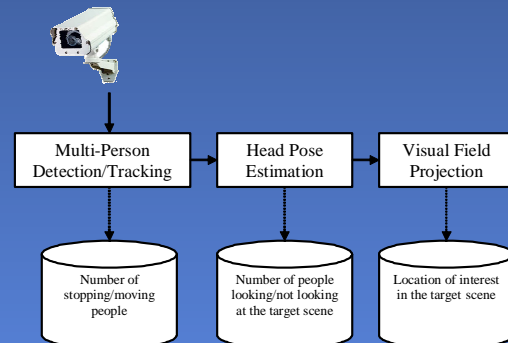

Multi-person Detection / Tracking

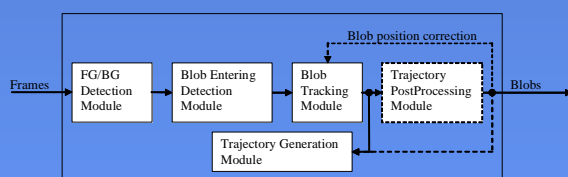

VISUAL FIELD PROJECTION

❖ ABCD: the zone seen by a person.

❖ O: represent the eyes.

❖ d: the distance between the point O and the rectangle ABCD

❖ L: the length, H: the height of the visual field

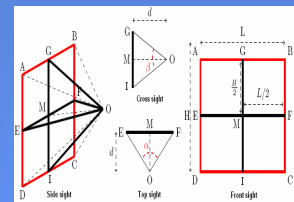

HEAD POSE ESTIMATION

Pan (Yaw)

Corresponds to a right/left head movement, around the y axis.

Tilt (Pitch)

Corresponds to a bottom/up head movement, around the x axis.

Roll (Slant)

Corresponds to a profile head movement, around the z axis.

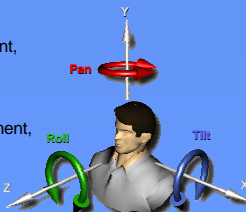

EXPERIMENTS

